

BLANK / * VERZINKTE HEKWERKMATTEN

| TYPE | | φ | Mazen (mm) | Afmetingen L x B (mm) | gewicht Kg /mat | stuks per pak |
|------|---|---|------------|------------------------|-----------------|---------------|
| | | 4 | 40-40 | 2000x1000 | 10,00 | 25 |
| | * | 3 | 50-50 | 2500x2000 | 11,49 | 25 |
| | | 4 | 50-50 | 2500x2000 | 22,00 | 25 |
| | | 4 | 50-50 | 5000x2000 | 39,00 | 25 |

VERZINKTE MESTROOSTERS

| | | | | | | |
|--|--|------|-------|-----------|-------|----|
| | | 3,40 | 75-25 | 2500x2000 | 19,63 | 25 |
|--|--|------|-------|-----------|-------|----|

AFSTANDHOUDER NEN6008

2 MTR

| | |
|-------|-------|
| 5 cm | 12 cm |
| 6 cm | 13 cm |
| 7 cm | 14 cm |
| 8 cm | 15 cm |
| 9 cm | 16 cm |
| 10 cm | 20 cm |
| 11 cm | 26 cm |

BETONSTAAL

FEB500HKN/HWL

| | |
|-------|----------|
| 6 mm | 6 mtr |
| 8 mm | 6+12 mtr |
| 10 mm | 6+12 mtr |
| 12 mm | 6+12 mtr |
| 16 mm | 6+12 mtr |
| 20 mm | 6+12 mtr |
| 25 mm | 12 mtr |
| 32 mm | 12 mtr |



IJZERLEEUEW



IJZERLEEUEW

Gasthuisdijk 15, 8041 AE | Postbus 123, 8000 AC Zwolle | T 31 38 4280777 | E info@ijzerleeuw.nl

www.ijzerleeuw.nl

www.ijzerleeuw.nl

STANDAARD NETTEN

| TYPE | | φ | Mazen (mm) | Afmetingen L x B (mm) | gewicht Kg /mat | stuks per pak |
|----------|---|----|------------|------------------------|-----------------|---------------|
| QS 196 A | * | 5 | 100-100 | 3000x2000 | 18,48 | 50 |
| QS 283 A | | 6 | 100-100 | 3000x2000 | 26,64 | 50 |
| QS 503 A | | 8 | 100-100 | 3000x2000 | 47,40 | 30 |
| QS 130 A | * | 5 | 150-150 | 3000x2000 | 12,63 | 50 |
| QS 188 A | * | 6 | 150-150 | 3000x2000 | 18,20 | 50 |
| QS 335 A | * | 8 | 150-150 | 3000x2000 | 32,39 | 40 |
| P 262 | * | 5 | 75-75 | 5000x2000 | 41,34 | 30 |
| P196 | * | 5 | 100-100 | 5000x2000 | 30,80 | 50 |
| P084 | * | 4 | 150-150 | 5000x2000 | 12,97 | 50 |
| P131 | * | 5 | 150-150 | 5000x2000 | 20,17 | 50 |
| P189 | * | 6 | 150-150 | 5000x2000 | 29,08 | 50 |
| P335 | | 8 | 150-150 | 5000x2000 | 51,75 | 30 |
| P524 | | 10 | 150-150 | 5000x2000 | 80,83 | 20 |

* ook in verzinkt

B MATTEN MET STEKEINDEN

| TYPE | φ | Mazen (mm) | Afmetingen L x B (mm) | werk-ende m ² | gewicht Kg /mat | stuks per pak |
|---------|----|------------|------------------------|--------------------------|-----------------|---------------|
| B503A | 8 | 100-100 | 6000x2400 | 11,20 | 100,49 | 10 |
| B785A | 10 | 100-100 | 6000x2400 | 11,20 | 159,76 | 10 |
| B188A | 6 | 150-150 | 5950x2350 | 10,82 | 36,48 | 40 |
| B257A | 7 | 150-150 | 5950x2350 | 10,82 | 52,13 | 30 |
| BEC335A | 8 | 150-150 | 4450X2350 | 7,02 | 45,23 | 30 |
| B335A | 8 | 150-150 | 5950X2350 | 10,82 | 64,90 | 20 |
| B424A | 9 | 150-150 | 6000X2400 | 9,72 | 79,04 | 20 |
| B524A | 10 | 150-150 | 5950X2350 | 10,82 | 101,37 | 10 |
| B754A | 12 | 150-150 | 5950x2350 | 9,72 | 138,53 | 10 |

Afmetingen

Standaard netten

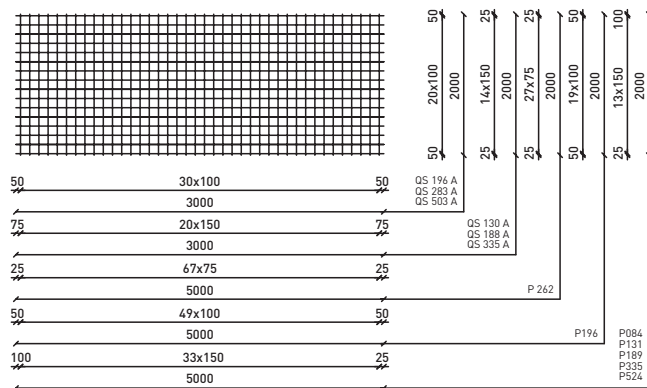

B matten met stekeinden

